

Technical data sheet



JHA Joist Hanger with Adjustable Height Strap

JHA is a height adjustable joist hanger for supporting timber joists from timber members. Available in standard leg (JHA270) and long leg (JHA450) versions.

Features

Material

- Pre-galvanised mild steel.

Features

- A galvanised joist hanger that provides great support with ease of installation.
- Published performance values are based upon 3.75 x 30mm square twist nails being used throughout.
- Wider strap provides more surface area on the supporting timber and allows increased nail spacing, enhancing the performance of the critical hanger-to-support part of the connection.
- Minimum and maximum nailing schedules are stamped into the strap providing correct installation information for site operatives.
- Speed-prong holds the hanger in position to allow easier attachment. The installer no longer has to try to hold hanger, joist and nail with one hand and swing a hammer with the other!
- JHA270 range features a location tab which allows easier alignment of the hanger.
- The model number and size is stamped into the seat of the hanger for easy identification, even after installation.

Applications

Suitable On

- **Solid sawn timber joists**

When to Use

- Face Fix
- Wrap Over

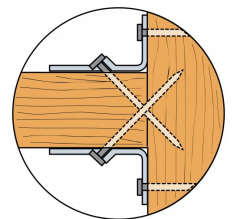
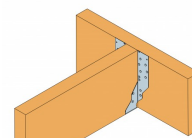
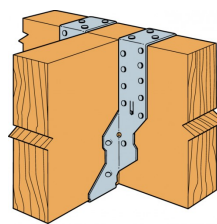

Double Shear Nailing.

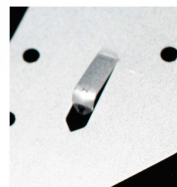

Speed Prongs
(JHA270)



Location Tab (JHA270)

JHA Joist Hanger with Adjustable Height Strap

Technical Data

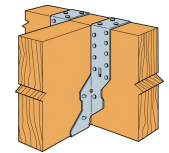

Product Dimensions - JHA270

References	Product Dimensions [mm]							Header holes	Joist holes
	A	B	C	D	E	F	t	Ø4	Ø6x4 Oblong
JHA270/38	38	241	50	48.8	106	52.1	0.9	22	4
JHA270/44	44	238	50	48.8	103	52.1	0.9	22	4
JHA270/47	47	236.5	50	48.8	101.5	52.1	0.9	24	4
JHA270/50	50	235	50	48.8	100	52.1	0.9	24	4
JHA270/63	63	248.5	50	48.8	113.5	52.1	0.9	22	4
JHA270/75	75	242.5	50	48.8	99.5	52.1	0.9	22	4
JHA270/91	91	234	50	48.8	95	52.1	0.9	22	4
JHA270/100	100	230	50	48.8	230	52.1	0.9	22	4

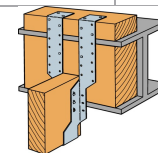

Product Dimensions - JHA450

JHA450 Below Support Installation.

References	Joist Size [mm]	Product Dimensions [mm]							Header holes	Joist holes
	Width	A	B	C	D	E	F	t	Ø4	Ø6x4 Oblong
JHA450/38	1x38	38	481	50	51.5	191	61.5	1.5	38	6
JHA450/44	1x44	44	478	50	51.5	188	61.5	1.5	38	6
JHA450/47	1x45	47	477	50	51.5	187	61.5	1.5	38	6
JHA450/50	1x50	50	475	50	51.5	185	61.5	1.5	38	6
JHA450/63	1x63	63	469	50	51.5	179	61.5	1.5	38	6
JHA450/75	1x75	75	463	50	51.5	173	61.5	1.5	38	6
JHA450/91	2x45	91	455	50	51.5	165	61.5	1.5	38	6
JHA450/100	2x50	100	450	50	51.5	160	61.5	1.5	38	6
JHA450/125	2x63	125	452.5	63	51.5	162.5	64.5	1.5	38	6
JHA450/137	3x45	137	446.5	63	51.5	156.5	64.5	1.5	38	6
JHA450/150	3x50	150	440	63	51.5	150	64.5	1.5	38	6

Technical data sheet



JHA Joist Hanger with Adjustable Height Strap

JHA270 - Wrap Over Installation

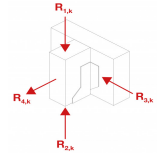
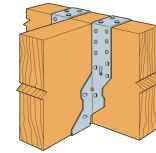

References	Header - Dimensions		Number of Fasteners			Characteristic capacities - Timber C16 [kN]		Safe Working Loads [kN]		
	Height		Header	Joist	Qty	$R_{1,k}$	$R_{2,k}$	$R_{1,SWL,Medium Term}$	$R_{1,SWL,Long term}$	Short Term Uplift
	Min	Max.	Face Qty	Top Qty		N3.75x30	N3.75x30	C16 header N3.75x30	C16 header N3.75x30	C16 Joist N3.75x30
JHA270/38	125	200	8	4	4	10	2.1	4.8	4.2	1.1
JHA270/44	125	200	8	4	4	11.6	2.1	5.5	4.8	1.1
JHA270/47	125	200	8	4	4	12.4	2.1	5.9	5.2	1.1
JHA270/50	125	200	8	4	4	13.1	2.1	6.2	5.5	1.1
JHA270/63	125	200	8	4	4	13.2	2.1	6.3	5.5	1.1
JHA270/75	125	200	8	4	4	13.2	2.1	6.3	5.5	1.1
JHA270/91	125	200	8	4	4	13.2	2.1	6.3	5.5	1.1
JHA270/100	125	200	8	4	4	13.2	2.1	6.3	5.5	1.1

JHA450 - Wrap Over Installation

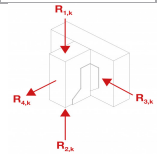
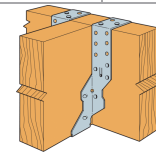

References	Number of Fasteners			Characteristic capacities - Timber C16 [kN]		Safe Working Loads [kN]		
	Header		Joist	$R_{1,k}$	$R_{2,k}$	$R_{1,SWL,Medium Term}$	$R_{1,SWL,Long term}$	Short Term Uplift
	Face Qty	Top Qty	Qty	N3.75x30	N3.75x30	C16 header N3.75x30	C16 header N3.75x30	C16 Joist N3.75x30
JHA450/38	8	4	6	10	3.1	4.8	4.2	1.6
JHA450/44	8	4	6	11.6	3.1	5.5	4.8	1.6
JHA450/47	8	4	6	12.4	3.1	5.9	5.2	1.6
JHA450/50	8	4	6	13.1	3.1	6.3	5.5	1.6
JHA450/63	8	4	6	13.2	3.1	6.3	5.5	1.6
JHA450/75	8	4	6	13.2	3.1	6.3	5.5	1.6
JHA450/91	8	4	6	13.2	3.1	6.3	5.5	1.6
JHA450/100	8	4	6	13.2	3.1	6.3	5.5	1.6
JHA450/125	8	4	6	13.6	3.1	6.5	5.7	1.6
JHA450/137	8	4	6	13.6	3.1	6.5	5.7	1.6
JHA450/150	8	4	6	13.6	3.1	6.5	5.7	1.6

Technical data sheet



JHA Joist Hanger with Adjustable Height Strap

JHA270 - Face Fix Installation

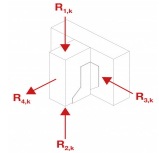
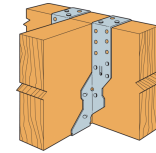

References	Header - Dimensions		Number of Fasteners			Characteristic capacities - Timber C16 [kN]		Safe Working Loads [kN]		
	Height		Header	Joist	Qty	$R_{1,k}$	$R_{2,k}$	$R_{1,SWL,Medium Term}$	$R_{1,SWL,Long term}$	Short Term Uplift
	Min	Max.	Face Qty	Top Qty		N3.75x30	N3.75x30	C16 header N3.75x30	C16 header N3.75x30	C16 Joist N3.75x30
JHA270/38	200	250	20	-	4	7.6	2.1	3.6	3.2	1.1
JHA270/44	200	250	20	-	4	7.6	2.1	3.6	3.2	1.1
JHA270/47	200	250	20	-	4	7.6	2.1	3.6	3.2	1.1
JHA270/50	200	250	20	-	4	7.6	2.1	3.6	3.2	1.1
JHA270/63	200	250	20	-	4	7.6	2.1	3.6	3.2	1.1
JHA270/75	200	250	20	-	4	7.6	2.1	3.6	3.2	1.1
JHA270/91	200	250	20	-	4	7.6	2.1	3.6	3.2	1.1
JHA270/100	200	250	20	-	4	7.6	2.1	3.6	3.2	1.1

JHA450 - Face Fix Installation

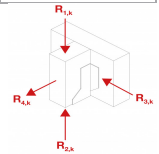

References	Number of Fasteners		Characteristic capacities - Timber C16 [kN]		Safe Working Loads [kN]		
	Header	Joist	$R_{1,k}$	$R_{2,k}$	$R_{1,SWL,Medium Term}$	$R_{1,SWL,Long term}$	Short Term Uplift
	Face Qty	Qty	N3.75x30	N3.75x30	C16 header N3.75x30	C16 header N3.75x30	C16 Joist N3.75x30
JHA450/38	20	6	10	3.1	4.8	4.2	1.6
JHA450/44	20	6	10.6	3.1	5.1	4.4	1.6
JHA450/47	20	6	10.6	3.1	5.1	4.4	1.6
JHA450/50	20	6	10.6	3.1	5.1	4.4	1.6
JHA450/63	20	6	10.6	3.1	5.1	4.4	1.6
JHA450/75	20	6	10.6	3.1	5.1	4.4	1.6
JHA450/91	20	6	10.6	3.1	5.1	4.4	1.6
JHA450/100	20	6	10.6	3.1	5.1	4.4	1.6
JHA450/125	20	6	11.6	3.1	5.5	4.8	1.6
JHA450/137	20	6	11.6	3.1	5.5	4.8	1.6
JHA450/150	20	6	11.6	3.1	5.5	4.8	1.6

Technical data sheet

SIMPSON

Strong-Tie

JHA
Joist Hanger with Adjustable Height Strap

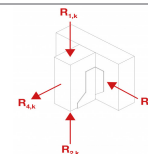

JHA450 - Below Support (Loft Conversion) Installation

References	Number of Fasteners			Characteristic capacities - Timber C16 [kN]		Safe Working Loads [kN]		
	Header		Joist	R _{1,k}	R _{2,k}	R _{1,SWL,Medium Term}	R _{1,SWL,Long term}	Short Term Uplift
	Face	Top	Qty	N3.75x30	N3.75x30	C16 header	C16 header	C16 Joist
	Qty	Qty				N3.75x30	N3.75x30	N3.75x30
JHA450/38-100	4	4	6	9.6	-	4.6	4	-
JHA450/125-150	4	4	6	10.1	-	4.8	4.2	-
JHA450/38-100 (alt)	20	-	6	9.6	-	4.6	4	-
JHA450/125-150 (alt)	20	-	6	10.1	-	4.8	4.2	-

JHA
Joist Hanger with Adjustable Height Strap

Installation

Installation

Alternative installation methods are available depending on the availability of nailing surface.

Maximum Nailing: All nails must be applied according to the table.

Minimum Nailing: For a lower installed cost the minimum nailing schedule can be used. A minimum wrap over of 45mm is required.

Loft Conversions (JHA450 Range): For applications where the hanger extends below the support. Install top, face, and joist nails according to the table. A minimum wrap over of 45mm is required or maximum nailing.

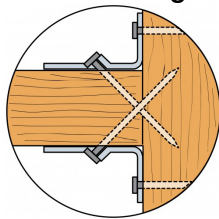

Double Shear Nailing.

